



PRODUCT SHEET  
**EVANESCENCE 6634**  
 66" X 34" X 28"



**FREESTANDING**

<b>THERMOMASSEUR® BATH</b>	\$
<b>TUB</b> no therapy	\$

THERMOMASSEUR (TMU)	
Jets	38
1 heated backrest	included
1 heated headrest	included
MiaMulti® Control *	included
Geysair®	included
AromaCloud®	N/A
Chromatherapy - 3 LED	\$
2 <sup>nd</sup> heated backrest (advanced technology)	\$

TUB no therapy	
AromaCloud®	N/A
Chromatherapy - 3 LED	\$
WarmTouchShell®	\$
DOT control	included with therapy
2 <sup>nd</sup> WarmTouchShell®	\$

FEATURES			
Installation			Freestanding
No. of bathers	2	Raised headrests	2
US gallons	55	Integrated waste & overflow	inst. & incl.
Imp. gallons	46		
WASTE & OVERFLOW			
Chrome, White			
Brass, Brushed Nickel, Polished Nickel			

**FEATURES INCLUDED**

COLOR	
Standard	
<input type="checkbox"/>	White

**OPTIONAL UPCHARGE APPLICABLE**

FINISH	
UltraVelour Matte Finish (White Only)	\$
ISLAND TUB DRAIN™**	
Island Tub Drain™	\$

 **DON'T FORGET THAT THIS MODEL IS AVAILABLE IN WHITE ONLY.**  
**DON'T FORGET TO SPECIFY THE FINISH OF THE INTEGRATED WASTE & OVERFLOW.**  
 \* CONTROL AND FAUCET CANNOT BE INSTALLED ON THE DECK OF THE BATH.  
 \*\* AN ISLAND TUB DRAIN IS REQUIRED WHEN THERE IS NO ACCESS UNDER THE BATH.

1 800 463.2187   
 info@bainultra.com

From 8 a.m. to 8 p.m. Monday to Thursday (EST)  
 From 8 a.m. to 5 p.m. on Friday (EST)



The quest for your wellness®

www.bainultra.com

# EVANESCENCE 6634 66" X 34" X 28"

## ACCESSORIES (OPTIONAL)

CUTTING TEMPLATE

# 90000065

### OTHERS

- Faucet must be freestanding or wall-mounted.
- The turbine must be remotely installed.
- Controls cannot be installed on the deck of the bath.

TOTAL PRICE

\$

## FREESTANDING INSTALLATION

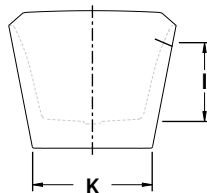
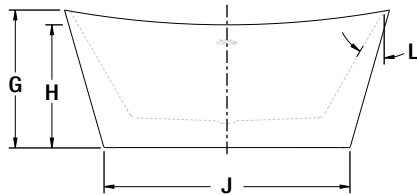
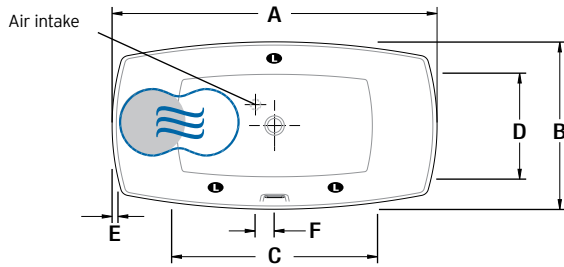

LETTER	DESCRIPTION	MEASURE
A	Total length	66"
B	Total width	34"
C	Bathing well length	41 7/8"
D	Bathing well width	21 1/2"
E	Deck width	1 1/4"
F	Center waste to air intake	4 1/4"
G	Total height to headrest	28"
H	Minimum height to center	25"
I	Maximum water level	16"
J	Base length	50"
K	Base width	24 1/4"
L	Slope of backrest	31°

Indicates LED light position

Indicates heated backrest (TMU)

Indicates WarmTouchShell position (TMSU)

## TECHNICAL SPECIFICATIONS

<b>Hot water supply required</b>	Should be 70% of water capacity of tub or greater.
<b>Turbine</b>	Access to the pump must be at least 18" X 22". <b>Standard connection is 20 A, 120 V, 60 hz</b> , dedicated line with a Ground-Fault Circuit Interrupter (GFCI). <b>For any additional option, a second line is needed 15 A, 120 V, 60 hz</b> , dedicated line with a GFCI. Air vent necessary: 2" X 4" minimum

Our products must be installed by certified professionals only and according to our Owner's Manual as well as federal, provincial/state and local building codes and regulations ([www.bainultra.com/documentation/documentation](http://www.bainultra.com/documentation/documentation)).

<b>Approx. shipping weight</b>	230 lbs
<b>Turbine power</b>	755 W
<b>Air heater</b>	700 W

## WARRANTY

Controls-LED-Geysair*	5 years
Bath & turbine*	20 years

\*Some restrictions apply | [www.bainultra.com/warranty](http://www.bainultra.com/warranty)



The specifications shown indicate the outer edge dimension and the inside bathing capacity dimension measured at air jets' height. The manufacturer accepts a 1/4" [0,64 cm] variance. There are variations on each product and specifications are subject to change as we improve upon our product as required. The dimensions needed for site preparation and structure building will differ. BainUltra® assumes no responsibility for preparatory work done prior to the product being on site.