

# PRODUCT SHEET

# MONARCH 6636

66" X 36" X 20"



<b>THERMOMASSEUR® BATH</b>	\$
<b>TUB</b>	\$

THERMOMASSEUR (TMU)	
Jets	42
1 heated backrest	included
MiaPlus® Control (uninstalled)	included
Geysair®	included
AromaCloud®	N/A
Chromatherapy - 2 LED	\$
2 <sup>nd</sup> heated backrest	\$

TUB no therapy	
Chromatherapy - 2 LED	\$
WarmTouchShell®	\$
DOT control	included with therapy
2 <sup>nd</sup> WarmTouchShell®	\$

FEATURES			
Installation	Drop-in or Alcove (3 walls)		
No. of bathers		Imp. gallons	42
US gallons	50	Integrated waste & overflow	inst. & incl.
INTEGRATED WASTE & OVERFLOW			
Chrome, White			
Brass, Brushed Nickel, Polished Nickel			

FEATURES (INCLUDED)			
COLOR (INNER SHELL)	DECK COLOR		
<b>Standard</b>	<b>Standard</b>		
White	Grey Expo	Noka	Jet Black Lagos Blue

OPTIONAL UPCHARGE APPLICABLE	
FINISH (INNER SHELL)	
UltraVelour Matte Finish (White Only)	\$
DECK COLOR	
<b>Optional</b>	\$
Quasar Light	Piatra Grey
Emperado	Tuscan Dawn
Statuario Maximus	
CONTROL (TMU ONLY)	
MiaMulti® (uninstalled)	\$
WASTE & OVERFLOW	
Chrome	\$
White	\$
Brass	\$
Brushed nickel, Polished nickel & Oil-rubbed bronze	\$
TILE FLANGE (specify front or back)	
Ordered with bath, uninstalled	\$
Factory installed	\$

DON'T FORGET THAT THIS MODEL IS AVAILABLE IN WHITE ONLY WITH CHOICE OF DECK COLOR. DON'T FORGET TO SPECIFY THE FINISH OF THE INTEGRATED WASTE & OVERFLOW.

1 800 463.2187   
info@bainultra.com

From 8 a.m. to 8 p.m. Monday to Thursday (EST)  
From 8 a.m. to 5 p.m. on Friday (EST)

**BainUltra®**  
The quest for your wellness™  
www.bainultra.com

# MONARCH 6636 66" X 36" X 20"

## ACCESSORIES (OPTIONAL)



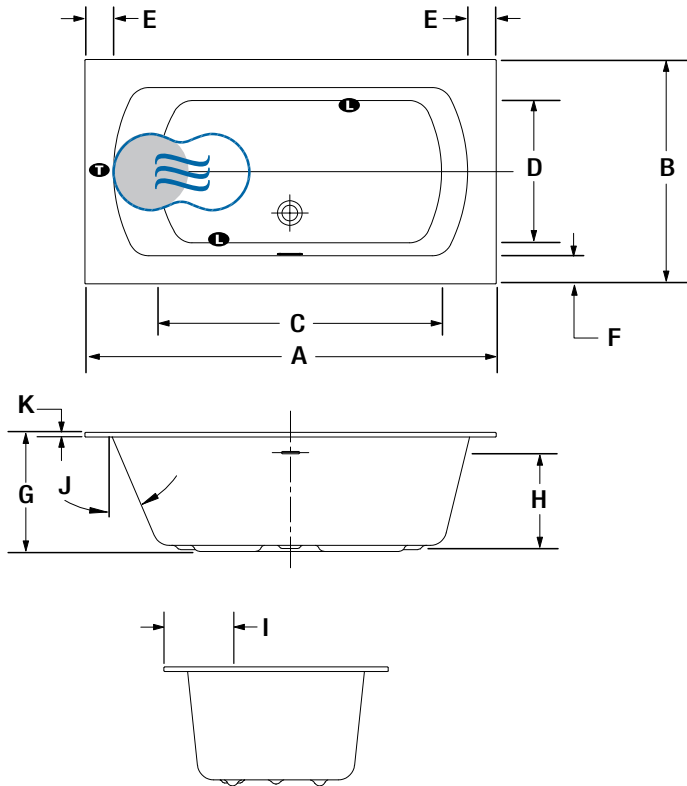

OTHER Control cannot be installed on the quartz deck.

TOTAL PRICE \$

## DROP-IN/ALCOVE INSTALLATION



LETTER	DESCRIPTION	MEASURE
A	Total length	66"
B	Total width	36"
C	Bathing well length (at height of jets)	46 1/8"
D	Bathing well width (at height of jets)	23 1/4"
E	Deck width (backrest)	4 3/4"
F	Deck width (sides)	4 5/8"
G	Tub height	19 5/8"
H	Height from waste to center of overflow	15 1/2"
I	Outside edge to center waste	11 3/8"
J	Slope of backrest	23°
K	Quartz deck height	3/4"

-  Indicates turbine position (TMU)
-  Indicates LED light position
-  Indicates WarmTouchShell position (TUB)
-  Indicates heated backrest (TMU)

## TECHNICAL SPECIFICATIONS

<b>Hot water supply required</b>	Should be 70% of water capacity of tub or greater.
<b>Turbine</b>	Access to the pump must be at least 18" X 22". <b>Standard connection is 20 A, 120 V, 60 hz, dedicated line with a Ground-Fault Circuit Interrupter (GFCI). For any additional option, a second line is needed 15 A, 120 V, 60 hz, dedicated line with a GFCI.</b>

Our products must be installed by certified professionals only and according to our Owner's Manual as well as federal, provincial/state and local building codes and regulations ([www.bainultra.com/documentation/documentation](http://www.bainultra.com/documentation/documentation)).

<b>Approx. shipping weight</b>	253 lbs
<b>Turbine power</b>	600 W
<b>Air heater</b>	600 W

## WARRANTY

Controls-LED-Geysair*	5 years
Quartz Deck*	15 years
Bath & turbine*	20 years

\*Some restrictions apply | [www.bainultra.com/warranty](http://www.bainultra.com/warranty)

The specifications shown indicate the outer edge dimension and the inside bathing capacity dimension measured at air jets' height. The manufacturer accepts a 1/4" [0,64 cm] variance. There are variations on each product and specifications are subject to change as we improve upon our product as required. The dimensions needed for site preparation and structure building will differ. BainUltra® assumes no responsibility for preparatory work done prior to the product being on site.

