



PRODUCT SHEET

TMU 5454

54" X 54" X 21"



THERMOMASSEUR® BATH	\$
TUB	N/A

THERMOMASSEUR (TMU)	
Jets	54
1 heated backrest & headrest	included
MiaPlus® Control	included
Geysair®	included
AromaCloud®	\$
Illuzio Chromatherapy NEW	\$
2 nd heated backrest (advanced technology)	\$

FEATURES			
Installation	Drop-in or Corner		
No. of bathers	2	Inverted V	2
US gallons	61	Armrests	2
Imp. gallons	51	Grab bars	2
Raised seats	2	Wood seat - shelf	included

COLOR	
Standard	
White	Biscuit

OPTIONAL UPCHARGE APPLICABLE			
COLOR			
Optional	\$		
	Gray		
CONTROL			
MiaMulti®	\$		
SKIRT	SJ-3 TMU 5454	(Step with wood insert)	(Without step)
Skirt	\$	\$	\$
Optional color	\$	\$	\$
STEP (ALONE)			
With wood insert	\$		
Optional color	\$		
CLEAR ACRYLIC GRAB BARS			
With Chrome, Brass or Brushed nickel inserts	\$		
WASTE & OVERFLOW			
	16" X 35"		
Chrome	\$		
White & Biscuit	\$		
Brass	\$		
Brushed nickel, Polished nickel & Oil-rubbed bronze	\$		
TILE FLANGE			
Ordered with bath, uninstalled	\$		
Factory-installed	\$		

DON'T FORGET THAT A STEP IS AVAILABLE TO COMPLETE THE ORDER.

1 800 463.2187 From 8 a.m. to 8 p.m. Monday to Thursday (EST)
 info@bainultra.com From 8 a.m. to 5 p.m. on Friday (EST)

TMU 5454 54" X 54" X 21"

ACCESSORIES (OPTIONAL)

CUTTING TEMPLATE

90000027

OTHERS

- Optional tile flange.
- Overall dimensions are 58 3/8" X 58 3/8" (see drawing for details).

TOTAL PRICE

\$

DROP-IN/CORNER INSTALLATION

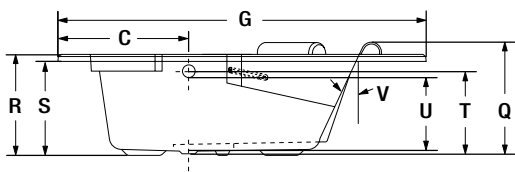
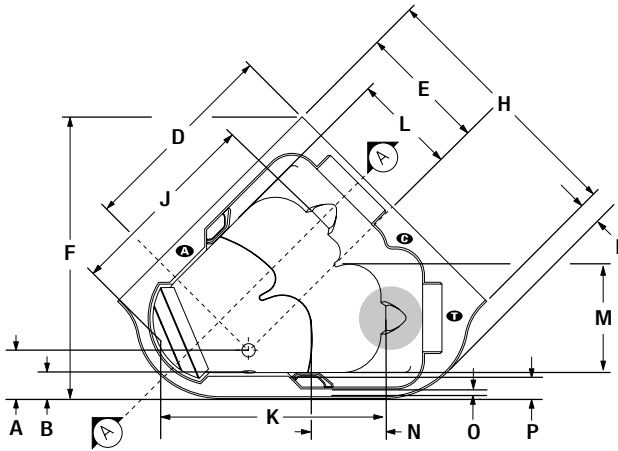

A section

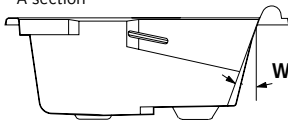

LETTER	DESCRIPTION	MEASURE
A	Outside edge to center drain	11 7/8"
B	Outside edge to overflow	5 7/8"
C	Sidecorner to center drain	27 1/8"
D	Sidewall to center drain	40 3/8"
E	Sidewall to center drain	25"
F	Total length	58"
G	Total width	76"
H	Sidewall length	53 7/8"
I	Length from sidecorner to front curve	4 1/2"
J	Bathing well length	40 7/8"
K	Bathing well length	45"
L	Bathing well width	19"
M	Bathing well width	20 3/4"
N	Raised seat length	17"
O	Deck width (narrowest point)	1 5/8"
P	Deck width (widest point)	5 3/4"
Q	Total height to headrest	23"
R	Height from bottom of tub to top deck	21"
S	Height from bottom of tub to bottom of lip	19 1/2"
T	Height from drain to center of overflow	16 5/8"
U	Maximum water level	14 7/8"
V	Slope of backrest	26°
W	Slope of backrest	20°

- A** AromaCloud position
- C** Control position when factory-installed (Mia or Dot)
- T** Turbine position (TMU)
- Heated backrest (TMU)

TECHNICAL SPECIFICATIONS

Hot water supply required Should be 70% of water capacity of tub or greater.

Turbine Access to the pump must be at least 18" X 22". **Standard connection is 20 A, 120 V, 60 hz,** dedicated line with a Ground-Fault Circuit Interrupter (GFCI). **For any additional option, a second line is needed 15 A, 120 V, 60 hz,** dedicated line with a GFCI. Air vent necessary: 2" X 4" minimum

Our products must be installed by certified professionals only and according to our Owner's Manual as well as federal, provincial/state and local building codes and regulations (www.bainultra.com/documentation/documentation).

Approx. shipping weight 155 lbs

Turbine power 550 W

Air heater 600 W

WARRANTY

Controls-LED-Geysair* 5 years

Bath & turbine* 20 years

*Some restrictions apply | www.bainultra.com/warranty



The specifications shown indicate the outer edge dimension and the inside bathing capacity dimension measured at air jets' height. The manufacturer accepts a 1/4" [0,64 cm] variance. There are variations on each product and specifications are subject to change as we improve upon our product as required. The dimensions needed for site preparation and structure building will differ. BainUltra® assumes no responsibility for preparatory work done prior to the product being on site.



PRODUCT SHEET

TMU 6060

60" X 60" X 21"



THERMOMASSEUR® BATH	\$
TUB	N/A

THERMOMASSEUR (TMU)	
Jets	58
1 heated backrest & headrest	included
MiaPlus® Control	included
Geysair®	included
AromaCloud®	\$
Illuzio Chromatherapy NEW	\$
2 nd heated backrest (advanced technology)	\$

FEATURES			
Installation	Drop-in or Corner		
No. of bathers	2	Inverted V	2
US gallons	67	Armrests	2
Imp. gallons	56	Grab bars	2
Raised seats	2	Wood seat - shelf	included

COLOR	
Standard	
White	Biscuit

OPTIONAL UPCHARGE APPLICABLE			
COLOR			
Optional	\$		
	Gray		
CONTROL			
MiaMulti®	\$		
SKIRT	SJ-3 TMU 6060	(Step with wood insert)	(Without step)
Skirt	\$	\$	\$
Optional color	\$	\$	\$
STEP (ALONE)			
With wood insert	\$		
Optional color	\$		
CLEAR ACRYLIC GRAB BARS			
With Chrome, Brass or Brushed nickel inserts	\$		
WASTE & OVERFLOW			16" X 35"
Chrome	\$		
White & Biscuit	\$		
Brass	\$		
Brushed nickel, Polished nickel & Oil-rubbed bronze	\$		
TILE FLANGE			
Ordered with bath, uninstalled	\$		
Factory-installed	\$		

DON'T FORGET THAT A STEP IS AVAILABLE TO COMPLETE THE ORDER.

1 800 463.2187 info@bainultra.com | From 8 a.m. to 8 p.m. Monday to Thursday (EST)
From 8 a.m. to 5 p.m. on Friday (EST)

TMU 6060 60" X 60" X 21"

ACCESSORIES (OPTIONAL)

CUTTING TEMPLATE

90000027

OTHERS

- Optional tile flange.
- Overall dimensions are 62 7/8" X 62 7/8" (see drawing for details).

TOTAL PRICE

\$

DROP-IN/CORNER INSTALLATION

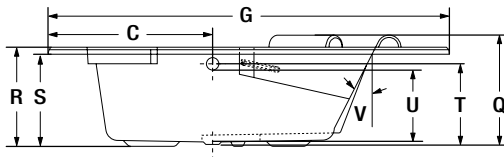
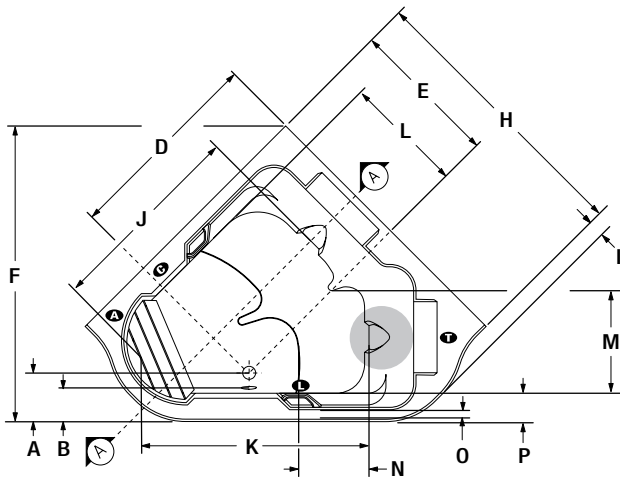

A section

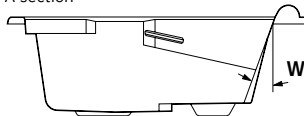

LETTER	DESCRIPTION	MEASURE
A	Outside edge to center drain	12 3/8"
B	Outside edge to overflow	6 1/2"
C	Sidecorner to center drain	34 3/4"
D	Sidewall to center drain	41"
E	Sidewall to center drain	29 7/8"
F	Total length	62"
G	Total width	83 3/4"
H	Sidewall length	59 3/4"
I	Length from sidecorner to front curve	3 1/8"
J	Bathing well length	44"
K	Bathing well length	50"
L	Bathing well width	21 3/4"
M	Bathing well width	19 1/4"
N	Raised seat length	18 1/2"
O	Deck width (narrowest point)	1 5/8"
P	Deck width (widest point)	6"
Q	Total height to headrest	23 5/8"
R	Height from bottom of tub to top deck	21"
S	Height from bottom of tub to bottom of lip	19 1/2"
T	Height from drain to center of overflow	16 5/8"
U	Maximum water level	15 1/8"
V	Slope of backrest	30°
W	Slope of backrest	23°

- A** AromaCloud position
- G** Control position when factory-installed (Mia or Dot)
- T** Turbine position (TMU)
- Heated backrest (TMU)

TECHNICAL SPECIFICATIONS

Hot water supply required Should be 70% of water capacity of tub or greater.

Turbine Access to the pump must be at least 18" X 22". **Standard connection is 20 A, 120 V, 60 hz**, dedicated line with a Ground-Fault Circuit Interrupter (GFCI). **For any additional option, a second line is needed 15 A, 120 V, 60 hz**, dedicated line with a GFCI. Air vent necessary: 2" X 4" minimum

Our products must be installed by certified professionals only and according to our Owner's Manual as well as federal, provincial/state and local building codes and regulations (www.bainultra.com/documentation/documentation).

The specifications shown indicate the outer edge dimension and the inside bathing capacity dimension measured at air jets' height. The manufacturer accepts a 1/4" [0,64 cm] variance. There are variations on each product and specifications are subject to change as we improve upon our product as required. The dimensions needed for site preparation and structure building will differ. BainUltra® assumes no responsibility for preparatory work done prior to the product being on site.

Approx. shipping weight 191 lbs

Turbine power 550 W

Air heater 600 W

WARRANTY

Controls-LED-Geysair* 5 years

Bath & turbine* 20 years

*Some restrictions apply | www.bainultra.com/warranty

