

PRODUCT SHEET  
**TMU 5454**  
 54" X 54" X 21"



<b>THERMOMASSEUR® BATH</b>	\$
<b>THERMASENS® BATH</b>	N/A
<b>TUB</b>	N/A

THERMOMASSEUR (TMU)	
Jets	54
1 heated backrest	included
1 heated headrest	included
MiaPlus® Control	included
Geysair®	included
AromaCloud®	\$
Chromatherapy - 2 LED	\$
2 <sup>nd</sup> heated backrest (advanced technology)	\$

FEATURES			
Installation	Drop-in or Corner		
No. of bathers		Inverted V	2
US gallons	61	Armrests	2
Imp. gallons	51	Grab bars	2
Raised seats	2	Wood seat - shelf	included

COLOR	
<b>Standard</b>	
White	Biscuit

OPTIONAL UPCHARGE APPLICABLE			
<b>COLOR</b>			
<b>Optional</b>			\$
Black	Sandbar	Gray	
<b>CONTROL</b>			
MiaMulti®			\$
<b>SKIRT</b>	<b>SJ-3 TMU 5454</b>	<b>(Step with wood insert)</b>	<b>(Without step)</b>
Skirt	\$	\$	\$
Optional color	\$	\$	\$
<b>STEP (ALONE)</b>			
With wood insert			\$
Optional color			\$
<b>CLEAR ACRYLIC GRAB BARS</b>			
With Chrome, Brass or Brushed nickel inserts			\$
<b>WASTE &amp; OVERFLOW</b>		<b>16" X 35"</b>	
Chrome			\$
White & Biscuit			\$
Brass			\$
Brushed nickel, Polished nickel & Oil-rubbed bronze			\$
<b>TILE FLANGE</b>			
Ordered with bath, uninstalled			\$
Factory-installed			\$

DON'T FORGET THAT A STEP IS AVAILABLE TO COMPLETE THE ORDER.

1 800 463.2187 info@bainultra.com | From 8 a.m. to 8 p.m. Monday to Thursday (EST)  
 From 8 a.m. to 5 p.m. on Friday (EST)

# TMU 5454 54" X 54" X 21"

## ACCESSORIES (OPTIONAL)

CUTTING TEMPLATE

# 90000027

OTHERS

- Optional tile flange.
- Overall dimensions are 58 3/8" X 58 3/8" (see drawing for details).

TOTAL PRICE

\$

## DROP-IN/CORNER INSTALLATION

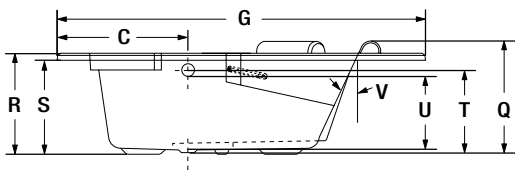
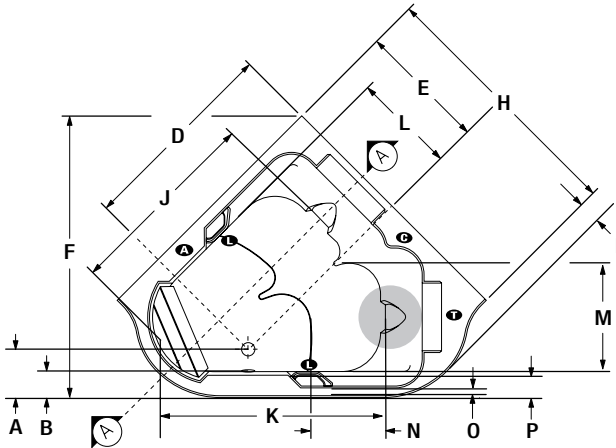

A section

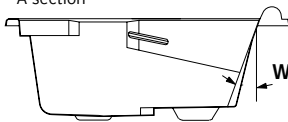

LETTER	DESCRIPTION	MEASURE
A	Outside edge to center drain	11 7/8"
B	Outside edge to overflow	5 7/8"
C	Sidescorner to center drain	27 1/8"
D	Sidewall to center drain	40 3/8"
E	Sidewall to center drain	25"
F	Total length	58"
G	Total width	76"
H	Sidewall length	53 7/8"
I	Length from sidescorner to front curve	4 1/2"
J	Bathing well length	40 7/8"
K	Bathing well length	45"
L	Bathing well width	19"
M	Bathing well width	20 3/4"
N	Raised seat length	17"
O	Deck width (narrowest point)	1 5/8"
P	Deck width (widest point)	5 3/4"
Q	Total height to headrest	23"
R	Height from bottom of tub to top deck	21"
S	Height from bottom of tub to bottom of lip	19 1/2"
T	Height from drain to center of overflow	16 5/8"
U	Maximum water level	14 7/8"
V	Slope of backrest	26°
W	Slope of backrest	20°

Ⓡ Indicates turbine position (TMU)

Ⓢ Indicates control position when factory-installed

● Indicates heated backrest (TMU)

Ⓛ Indicates LED light position

ⓐ Indicates AromaCloud position

## TECHNICAL SPECIFICATIONS

Hot water supply required

Should be 70% of water capacity of tub or greater.

Turbine

Access to the pump must be at least 18" X 22". **Standard connection is 20 A, 120 V, 60 hz, dedicated line with a Ground-Fault Circuit Interrupter (GFCI). For any additional option, a second line is needed 15 A, 120 V, 60 hz, dedicated line with a GFCI. Air vent necessary: 2" X 4" minimum**

Our products must be installed by certified professionals only and according to our Owner's Manual as well as federal, provincial/state and local building codes and regulations ([www.bainultra.com/documentation/documentation](http://www.bainultra.com/documentation/documentation)).

Approx. shipping weight

155 lbs

Turbine power

755 W

Air heater

700 W

## WARRANTY

Controls-LED-Geysair\*

5 years

Bath & turbine\*

20 years

\*Some restrictions apply | [www.bainultra.com/warranty](http://www.bainultra.com/warranty)



The specifications shown indicate the outer edge dimension and the inside bathing capacity dimension measured at air jets' height. The manufacturer accepts a 1/4" [0,64 cm] variance. There are variations on each product and specifications are subject to change as we improve upon our product as required. The dimensions needed for site preparation and structure building will differ. BainUltra® assumes no responsibility for preparatory work done prior to the product being on site.